

DESCRIPTION

The Duct Probes come in two sizes, 1" and 8", and are specific to the application. The probes are simple pickup tubes that get installed in the ductwork of the monitored zones. A 1" probe is typically used in laboratory applications for monitoring the general exhaust where the 8" probe is specific to the chemical-monitored exhaust application and gets installed in risers, or the mixing box section of the exhaust fan stack.

SPECIFICATIONS



Material	Glass Reinforced Nylon 6.6
Color	Black
Dimensions (WxHxD)	1.5"L x 0.75"H x 0.75"W
Weight	0.4 oz
Connections	(1) ¼" Push-to-Connect
Part Number	AXDPA0001



Material	304 Stainless Steel
Color	Silver
Dimensions (WxHxD)	9.25"L x 1.75"H x 1.75"W
Weight	0.2 lbs
Connections	(1) ¼" Push-to-Connect
Part Number	AXDPA0008



Material	Aluminum
Color	Silver
Dimensions (WxHxD)	7.75"L x 1.5"H x 1.5"W
Weight	0.5 oz
Connections	(1) ¼" Push-to-Connect
Part Number	AXDPA0006

ORDERING GUIDE

Selection	Quantity	Part #	Description
<input type="checkbox"/>	QTY ____	AX01DPA0001	1" Duct Probe
<input type="checkbox"/>	QTY ____	AX06DPA0001	6" Duct Probe
<input type="checkbox"/>	QTY ____	AX08DPA0001	8" Duct Probe

DRAWING

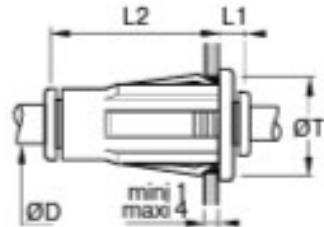

Minimum distance between fittings.
Diameter of fixing hole.

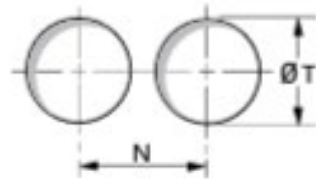

32PLPBHP Plug-in Bulkhead Union

PART NO.	TUBE SIZE IN	L1	L2	ØT
32PLPBHP-4	1/4	.26	1.240	.75

Fixing Hole

D		1/4
T	Inches	3/4"
	mm	19.05
N	In	1.00

Tolerance T: +0.3 -0.1

DRAWING CONT'D

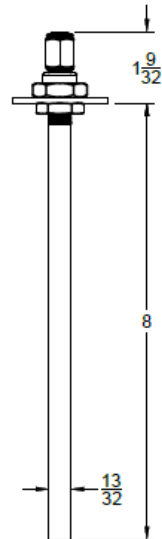
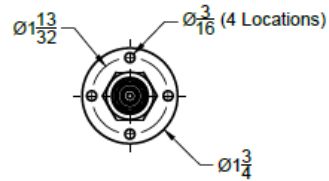

Notes

- 1) All dimensions are inches unless otherwise noted.
- 2) All components made of stainless steel.

		PROJECT AntrumX		
		TITLE 8" Duct Probe		
APPROVED	SIZE	CODE	DWG NO	REV
CHECKED	B			
DRAWN	Taylor Groll	10/13/2023	SCALE 1:1	WEIGHT
			SHEET 1/1	